

2015 Inspection Conference

October 11-14, 2015

Flamingo Las Vegas Sunset Ballroom Las Vegas, NV

VIPER
 2575 NORTHWEST PKWY
 ELCIN, IL 60124
 P: 847.426.3100
 F: 847.426.3111
 www.vipertradeshows.com

INFO
 MAX OCCUPANCY: 1248
 EXIT FEET: 36
 EXIT FEET REQD: 25
 SQ FT: 18720
 DIMENSIONS: 195'x96'

ALL DRAPE USED MEETS
 FLAME RETARDANT FIRE CODE

PILLAR DETAIL

BOOTH COUNTS
 ALL BOOTHS ARE 8' X 8'
 UNLESS NOTED

9-8'x16' BOOTHS
 3-16'x16' BOOTHS
 1-16'x24' BOOTHS
 26-8'x8' BOOTHS
 2-8'x40' BOOTHS
 1-8'x32' BOOTHS

SCALE
 1/16"=1'

DATE
 9.1.15

DISCLAIMER

Every effort has been made to ensure the accuracy of all information contained on this drawing. It is the responsibility of the user to verify all dimensions and locations. The user is responsible for any errors or omissions. The user is responsible for any damage to the building or contents, fixtures or other architectural components or items of any kind. It is the sole responsibility of the user to verify all dimensions and locations.

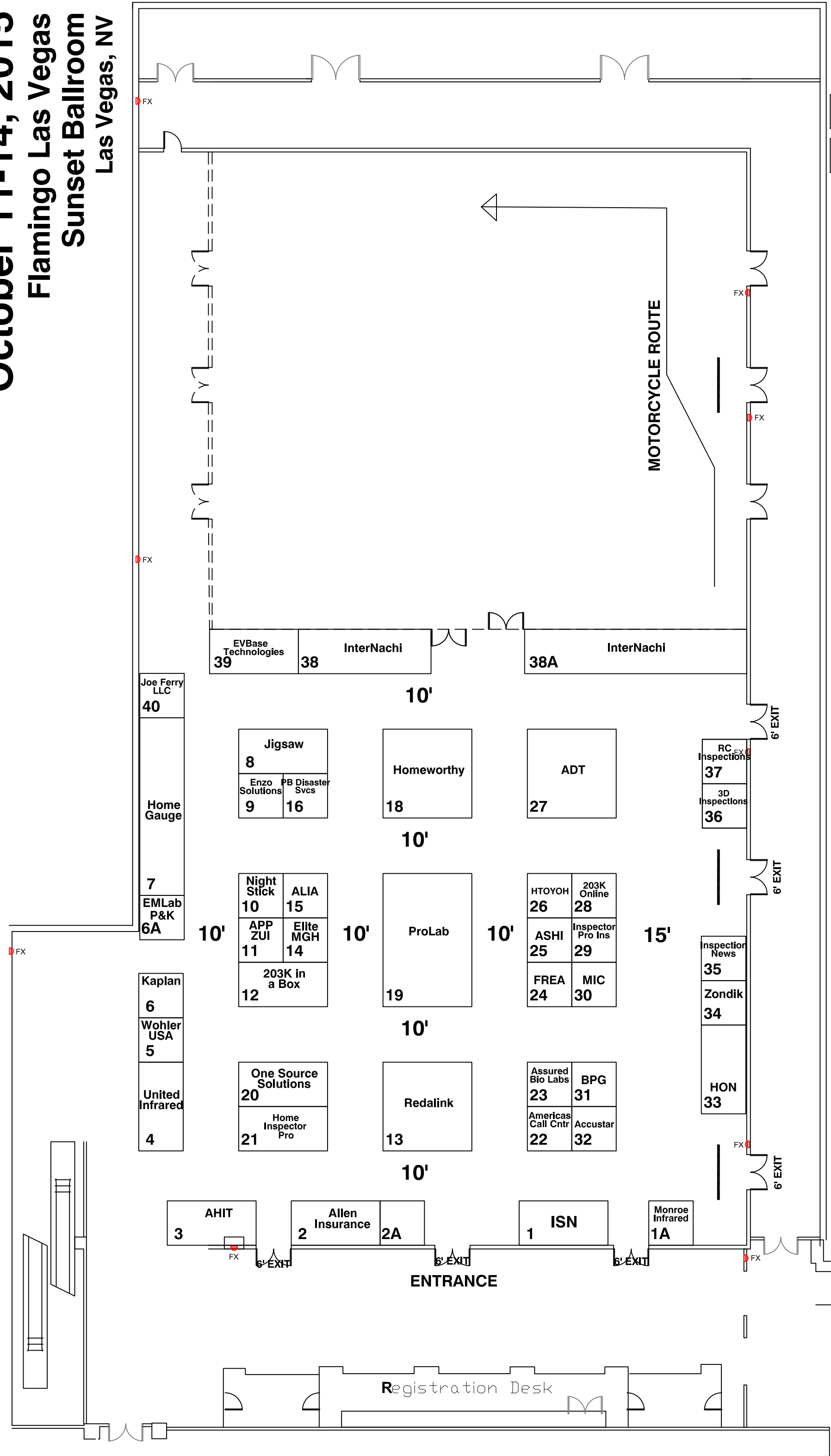

Batteries shall be disconnected in an approved manner, i.e. cable removed, tied back and /or electrically insulated from fueled vehicles.
 Fuel in the tank shall not exceed one-quarter (1/4) of the tank capacity or five gallons, whichever is less.
 Fuel tank openings shall be locked and sealed to prevent the escape of vapors.
 Vehicles, boats or other motorcraft equipment are not fueled or defueled within the building.
 A 36-inch wide access aisle or clear space shall be maintained around all sides of the displayed vehicle. (72 inches between vehicles displayed together.) Vehicles shall be a minimum of 20-feet from exit doors, exit stairs, the exit access or exit passageway.
 Vehicles shall not exhibit any leaks of any fluids

MAX OCCUPANCY 18720 sqft divided by 15 = 1248
 Linear footage of exits REQUIRED, 1248 divided by 50 = 25'